

SPECIFICATIONS

- 1、Current Rating: 2A AC, DC
- 2、Voltage Rating: 100V AC, DC
- 3、Temperature Range: -25°C~+85°C
- 4、Contact Resistance: 10mΩ Max
- 5、Insulation Resistance: 1000mΩ Min
- 6、Withstanding Voltang: 800V AC/minute
- 7、Material:Housing:Nylon66, UL94V-0

编 号	尺寸 (mm)		
	A	B	C
A2001H-02P	2.00	5.80	0.50
A2001H-03P	4.00	7.80	1.68
A2001H-04P	6.00	9.80	3.50
A2001H-05P	8.00	11.80	5.50
A2001H-06P	10.00	13.80	7.50
A2001H-07P	12.00	15.80	9.50
A2001H-08P	14.00	17.80	11.50
A2001H-09P	16.00	19.80	13.50
A2001H-10P	18.00	21.80	15.50
A2001H-11P	20.00	23.80	17.50
A2001H-12P	22.00	25.80	19.50
A2001H-15P	28.00	31.80	25.50

制图 DRAWN	变更内容 DESCRIPTION	日期 DATE	GENERAL TOLERANCE		制 图	陈雅	品名 TITLE PH孔座	页次 SHEET 1/1
			X.±0.25	X.±2°	审 核	洪章波		
			.X±0.20	.X±1°	核 准	魏杰	客户料号 CUST. NO.	
			.XX±0.15	.XX±0.5°	单 位 UNITS	MM	比例 SCALE	
			.XXX±0.10	.XXX±0.5°	比 例 SCALE	1:1		

www.ycelectron.com

深圳市裕城电子有限公司
SHENZHEN YUCHENG ELECTRONICS CO., LTD

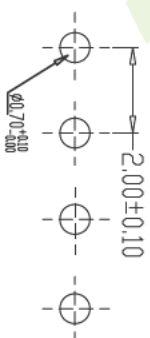
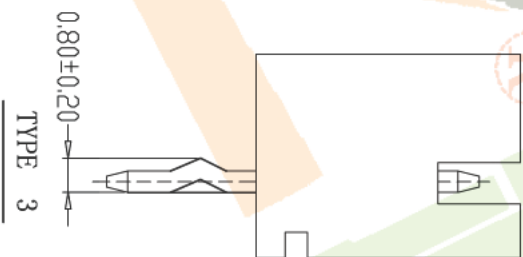
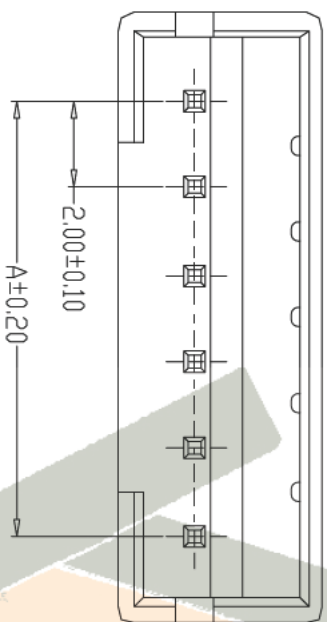
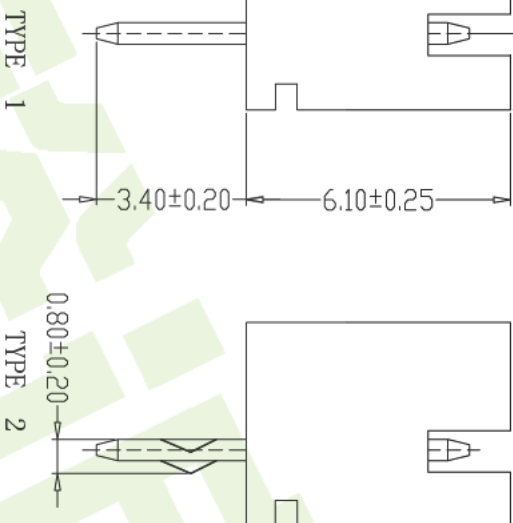
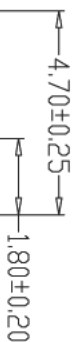
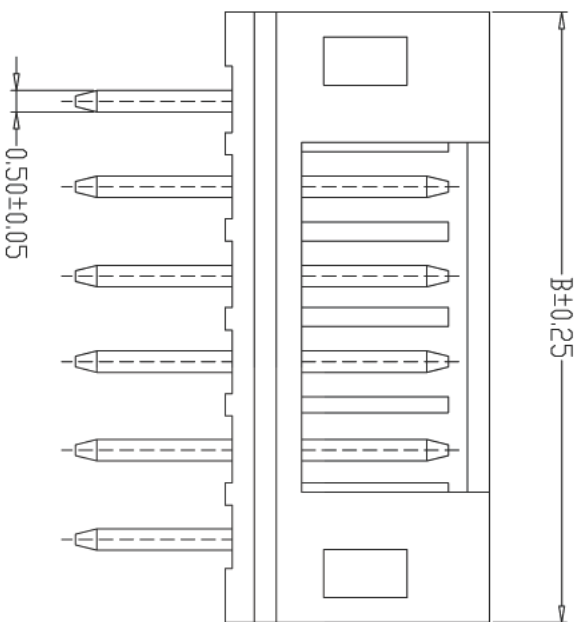

SPECIFICATIONS

- 1、Current Rating: 2A AC, DC
- 2、Voltage Rating: 100V AC, DC
- 3、Temperature Range: -25°C~+85°C
- 4、Contact Resistance: 10mΩ Max
- 5、Insulation Resistance: 1000mΩ Min
- 6、Withstanding Voltage: 800V AC/minute
- 7、Material: Wafer Nylon66, UL94V-0
PIN Brass Tin-plated

编 号	尺寸 (mm)	
	A	B
A2001WV-02A	2.00	6.00
A2001WV-03A	4.00	8.00
A2001WV-04A	6.00	10.00
A2001WV-05A	8.00	12.00
A2001WV-06A	10.00	14.00
A2001WV-07A	12.00	16.00
A2001WV-08A	14.00	18.00
A2001WV-09A	16.00	20.00
A2001WV-10A	18.00	22.00
A2001WV-11A	20.00	24.00
A2001WV-12A	22.00	26.00
A2001WV-15A	28.00	32.00

制图
DRAWN

变更内容
DESCRIPTION

日期
DATE

GENERAL TOLERANCE

制图
UNITS

陈雅

洪章波

魏杰

品名
TITLE
客户料号
CUST. NO.

PH直针座

页次
SHEET
1/1

www.ycelectron.com



深圳市裕诚电子有限公司
SHENZHEN YUCHENG ELECTRONICS CO., LTD

审核
核 准

MM

比例
SCALE
1:1

单位
UNITS

XXXX±0.10

X.±0.25

X.±2°

MM

XXXX±0.5°

XXXX±0.10

X.±0.15

X.±1°

MM

XXXX±0.5°

XXXX±0.10

X.±0.20

X.±2°

MM

XXXX±0.5°

XXXX±0.10

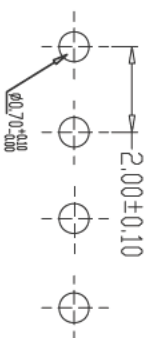
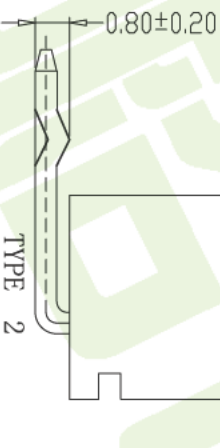
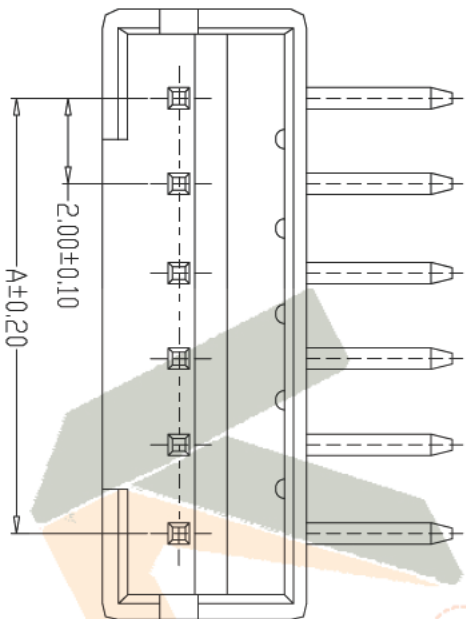
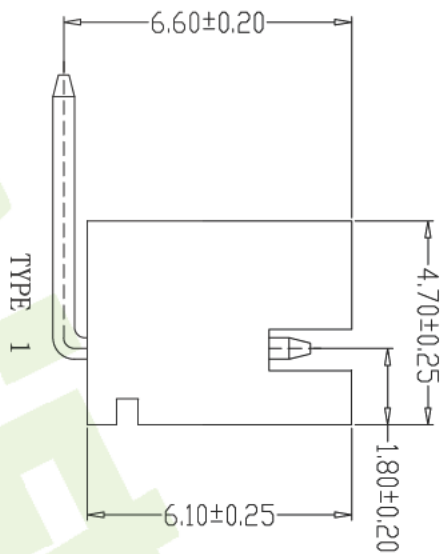
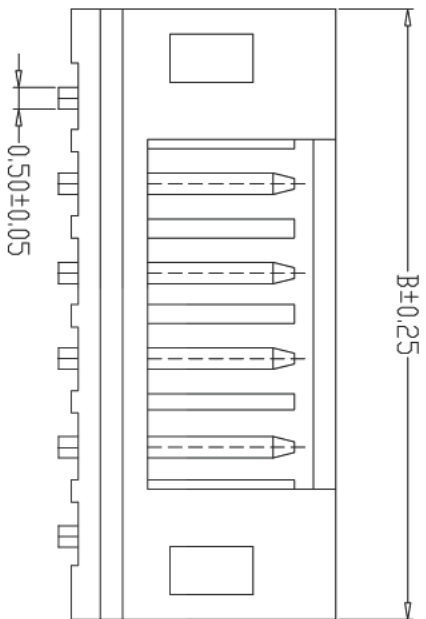

SPECIFICATIONS

- 1、Current Rating: 2A AC, DC
- 2、Voltage Rating: 100V AC, DC
- 3、Temperature Range: -25°C~+85°C
- 4、Contact Resistance: 10mΩ Max
- 5、Insulation Resistance: 1000mΩ Min
- 6、Withstanding Voltage: 800V AC/minute
- 7、Material: Wafer Nylon66, UL94V-0
PIN Brass Tin-plated

编 号	尺寸 (mm)	
	A	B
A2001WR-02A	2.00	6.00
A2001WR-03A	4.00	8.00
A2001WR-04A	6.00	10.00
A2001WR-05A	8.00	12.00
A2001WR-06A	10.00	14.00
A2001WR-07A	12.00	16.00
A2001WR-08A	14.00	18.00
A2001WR-09A	16.00	20.00
A2001WR-10A	18.00	22.00
A2001WR-11A	20.00	24.00
A2001WR-12A	22.00	26.00
A2001WR-15A	28.00	32.00

制图
DRAWN

变更内容
DESCRIPTION

日期
DATE

GENERAL TOLERANCE

制 图

陈雅

www.ycelectron.com

审 核

洪章波

品名
TITLE
PI弯针座

页次
SHEET
1/1

核 准

魏杰

客户料号

图例

单 位
UNITS

MM

比 例
SCALE
1:1

单 位
UNITS

MM

比 例
SCALE
1:1

单 位
UNITS

MM

比 例
SCALE
1:1

深圳市裕诚电子有限公司
SHENZHEN YUCHENG ELECTRONICS CO., LTD

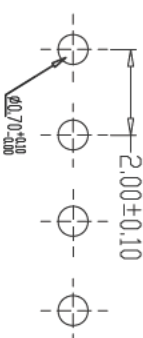
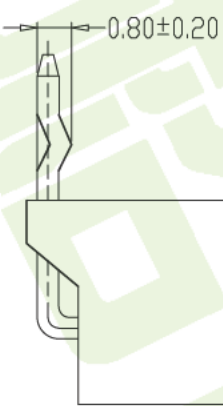
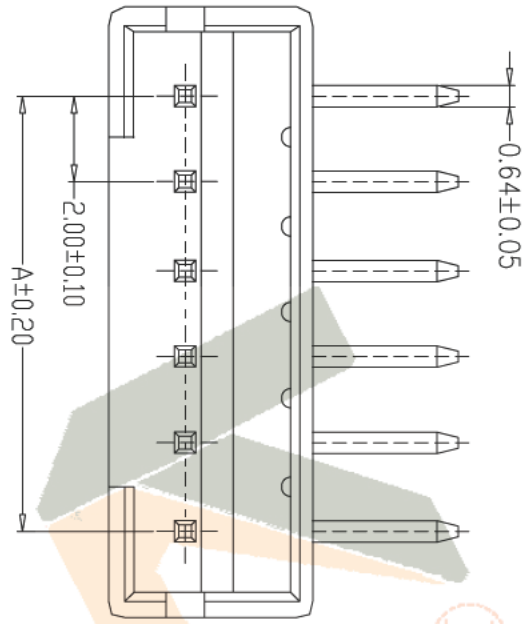
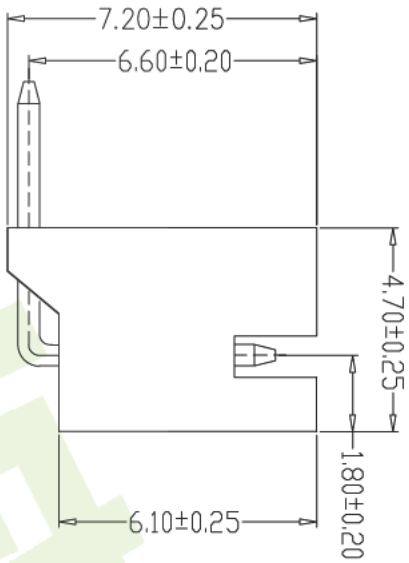
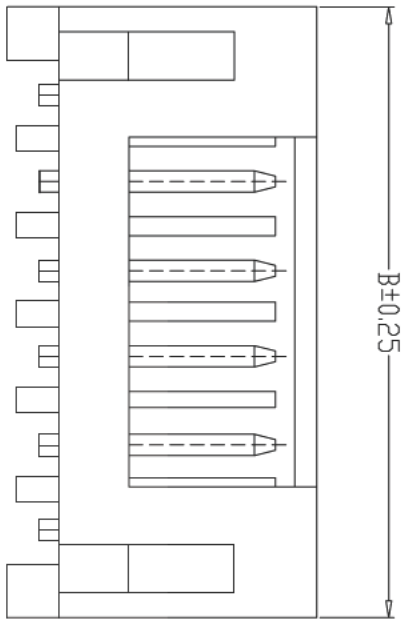

PCB LAYOUT

SPECIFICATIONS

- 1、Current Rating: 2A AC, DC
- 2、Voltage Rating: 100V AC, DC
- 3、Temperature Range: -25°C~+85°C
- 4、Contact Resistance: 10mΩ Max
- 5、Insulation Resistance: 1000mΩ Min
- 6、Withstanding Voltage: 800V AC/minute
- 7、Material: Wafer Nylon66, UL94V-0
PIN Brass Tin-plated

编号	尺寸 (mm)	
	A	B
A2001WRD-02A	2.00	6.00
A2001WRD-03A	4.00	8.00
A2001WRD-04A	6.00	10.00
A2001WRD-05A	8.00	12.00
A2001WRD-06A	10.00	14.00
A2001WRD-07A	12.00	16.00
A2001WRD-08A	14.00	18.00
A2001WRD-09A	16.00	20.00
A2001WRD-10A	18.00	22.00
A2001WRD-11A	20.00	24.00
A2001WRD-12A	22.00	26.00
A2001WRD-15A	28.00	32.00

变更内容 DESCRIPTION	日期 DATE	GENERAL TOLERANCE	
		X.±0.25	X.±2°
		.X±0.20	.X±1°
		.XX±0.15	.XX±0.5°
		.XXX±0.10	.XXX±0.5°

制图	审核
陈雅	洪章波

www.ycelectron.com		品名 TITLE	PH定位针座	页次 SHEET	A
		客户料号 CUST. NO.		1/1	

制图 DRAWN	审核	单位 UNITS	比例 SCALE
		MM	1:1

日期	描述

深圳市裕城电子有限公司
SHENZHEN YUCHENG ELECTRONICS CO., LTD

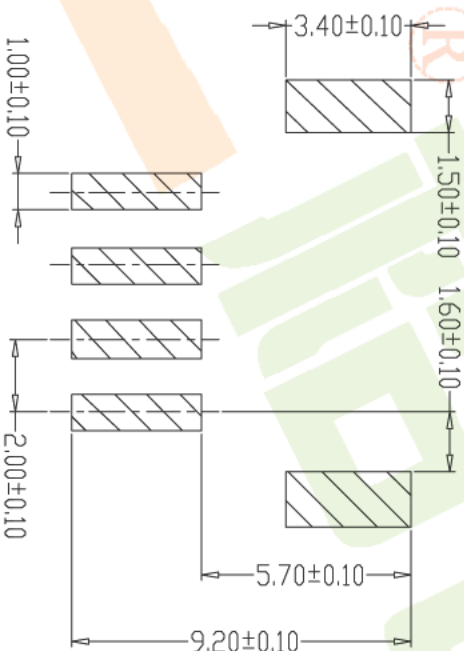
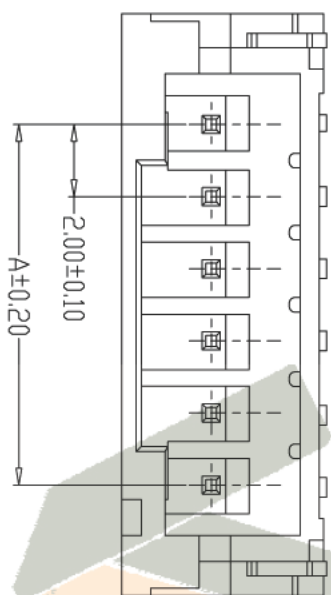
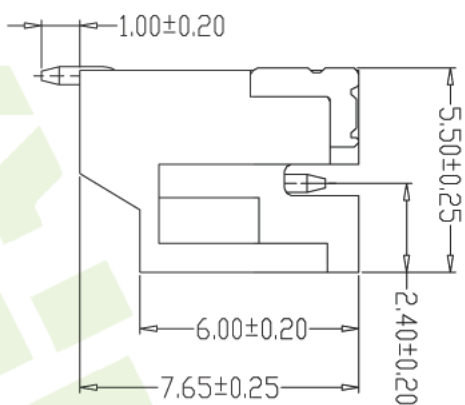
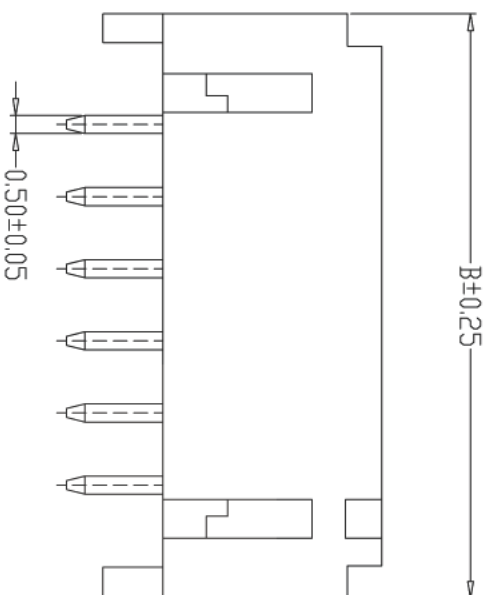

PCB LAYOUT

SPECIFICATIONS

- 1、Current Rating: 2A AC, DC
- 2、Voltage Rating: 100V AC, DC
- 3、Temperature Range: -25°C~+85°C
- 4、Contact Resistance: 10mΩ Max
- 5、Insulation Resistance: 1000mΩ Min
- 6、Withstanding Voltage: 800V AC/minute
- 7、Material: Wafer Nylon 9T, UL94V-0
PIN Brass Tin-plated
Solder tabs Phosphoric copper Tin-plated

编号	尺寸 (mm)	
	A	B
A2001WF-02A	2.00	8.00
A2001WF-03A	4.00	10.00
A2001WF-04A	6.00	12.00
A2001WF05A	8.00	14.00
A2001WF-06A	10.00	16.00
A2001WF-07A	12.00	18.00
A2001WF-08A	14.00	20.00
A2001WF-09A	16.00	22.00
A2001WF-10A	18.00	24.00
A2001WF-11A	20.00	26.00
A2001WF-12A	22.00	28.00
A2001WF-15A	28.00	34.00

制图
DRAWN

变更内容
DESCRIPTION

日期
DATE

GENERAL TOLERANCE

制图
UNITS

陈雅
洪章波

品名
TITLE
客户料号
CUST. NO.

PH贴针座

页次
SHEET
1/1

X.±0.25
X.±0.20
.XX±0.15
.XXX±0.10

审核
核准

魏杰

www.ycelectron.com



深圳市裕城电子有限公司
SHENZHEN YICHENG ELECTRONICS CO., LTD

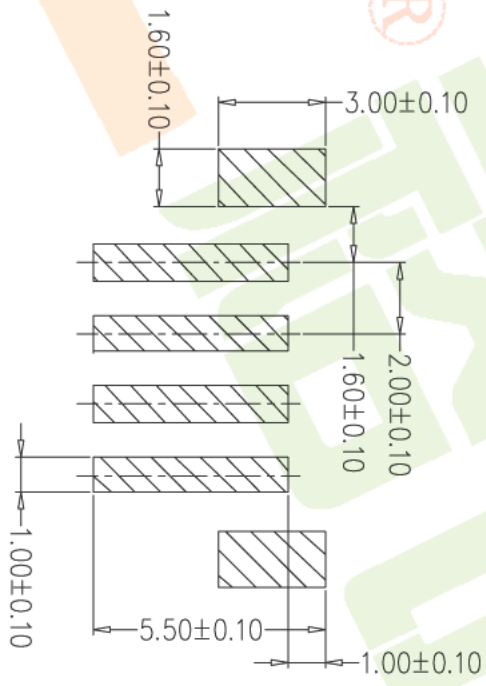
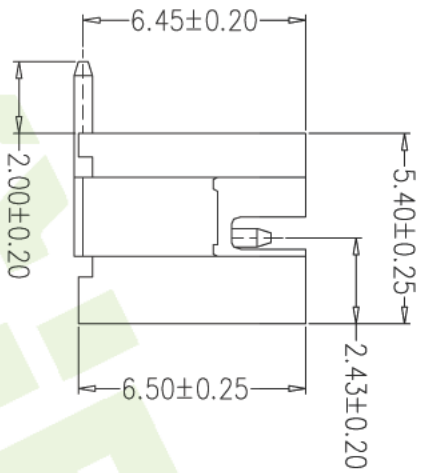
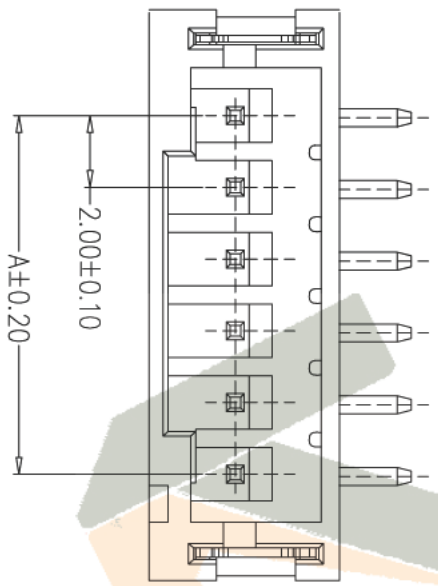
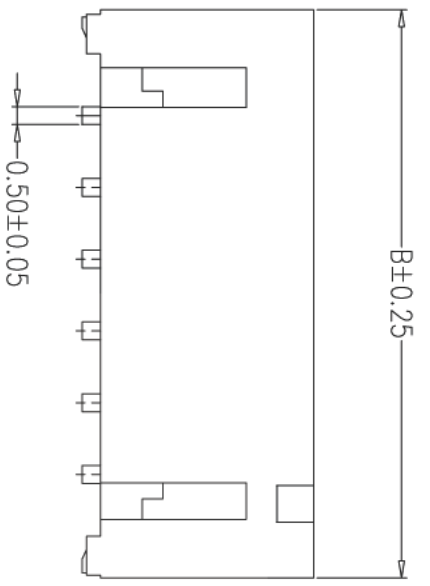

PCB LAYOUT

SPECIFICATIONS

- 1、Current Rating: 2A AC, DC
- 2、Voltage Rating: 100V AC, DC
- 3、Temperature Range: -25°C~+85°C
- 4、Contact Resistance: 10mΩ Max
- 5、Insulation Resistance: 1000mΩ Min
- 6、Withstanding Voltage: 800V AC/minute
- 7、Material: Wafer Nylon 9T, UL94V-0
PIN Brass Tin-plated
Solder tabs Phosphoric copper Tin-plated

编 号	尺寸 (mm)	
	A	B
A2001LF-02A	2.00	8.00
A2001LF-03A	4.00	10.00
A2001LF-04A	6.00	12.00
A2001LF-05A	8.00	14.00
A2001LF-06A	10.00	16.00
A2001LF-07A	12.00	18.00
A2001LF-08A	14.00	20.00
A2001LF-09A	16.00	22.00
A2001LF-10A	18.00	24.00
A2001LF-11A	20.00	26.00
A2001LF-12A	22.00	28.00
A2001LF-15A	28.00	34.00

制图	变更内容	日期	GENERAL TOLERANCE		制 图
DRAWN	DESCRIPTION	DATE	X.±0.25	X.±2°	审 核
			.X±0.20	.X±1°	核 准
			.XX±0.15	.XY±0.5°	
			.XXX±0.10	.XXX±0.5°	

陈雅	洪章波	魏杰	MM	SCALE	1:1
www.ycelectron.com	PH.立贴针座	品名	客户料号	TITLE	客户料号
		品名	客户料号	TITLE	客户料号
		品名	客户料号	TITLE	客户料号

www.ycelectron.com

深圳市裕城电子有限公司
SHENZHEN YUCHENG ELECTRONICS CO., LTD

1/1