

RoHS Compliant

REV. A/0	DESCRIPTION NEW	DESIGN CWF	DATE
-------------	--------------------	---------------	------

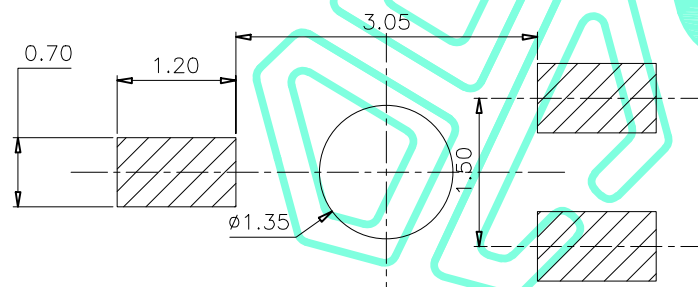
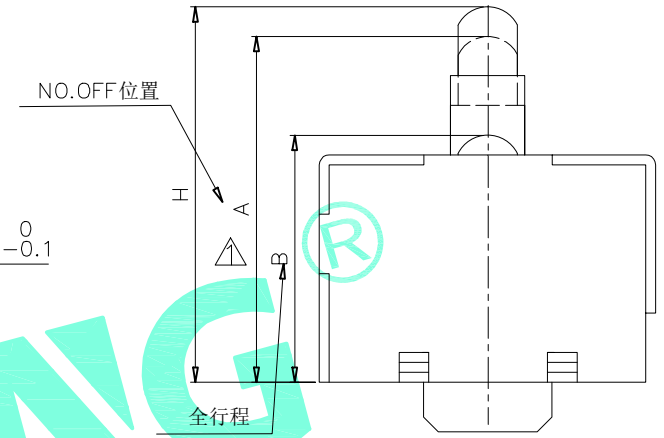
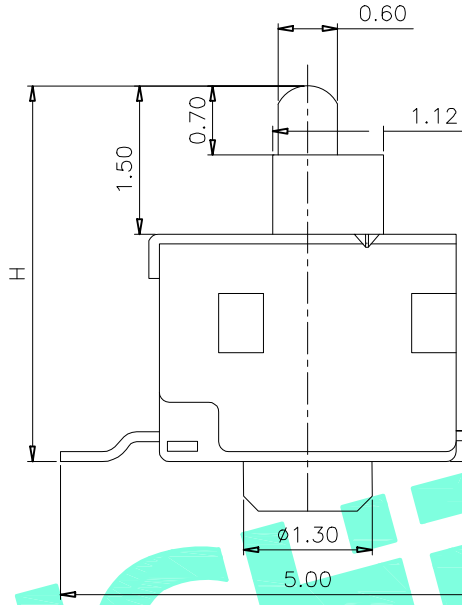
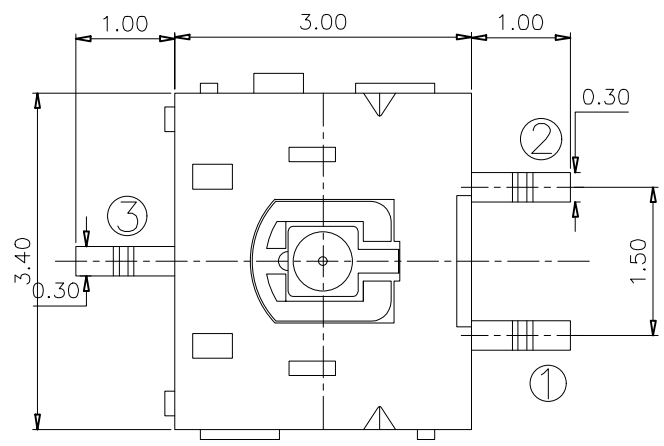

PCB Layout(Pattern side)

NOTE:  
 Rating: DC 30V 0.1A  
 Operating Force: 20±10gf  
 Lifetime: 50,000 Cycles  
 Packaging: 2800pcs/Reel

M5-1616E-W	M5-1616E-Y
PART NO.	

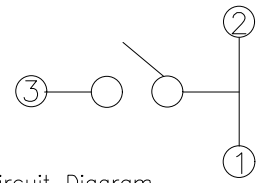

Circuit Diagram

NO.	Slider height(H)	ON start position(A)	Total travel(B)
01	3.8	3.5	2.5
02	4.1	3.8	2.9
03	4.8	4.5	3.6
04	5.2	4.9	4.0
05	5.5	5.2	4.3

ITEM	PART NAME	QTY.	MATERIAL	FINISHING
⑤	Contact Spring	1	Be Alloy	Ag Plated
④	Terminal	3	Brass	Ag Plated
③	Housing	1	PA46	Black
②	Cover	1	Brass	Ag Plated
①	Slider	1	PA46	Black

THESE DRAWINGS AND SPECIFICATIONS ARE THE PROPERTY OF SHENZHEN YUCHENG ELECTRONICS,LTD.AND SHALL NOT BE REPRODUCED,COPIED OR USED IN ANY MANNER WITHOUT THE PRIOR WRITTEN CONSENT OF SHENZHEN YUCHENG ELECTRONICS.,LTD

APPROVED: WEI JIE  
 CHECKED: HONG JIN YUN  
 DRAWING: CHEN YA

**UCHENG** 深圳市裕诚电子有限公司  
 ELECTRONICS SHENZHEN YUCHENG ELECTRONICS CO.,LTD

GENERAL TOLERANCES  
 30~以上 ±0.30  
 10~30 ±0.20  
 5~10 ±0.15  
 ~ 5 ±0.10

TITLE: DETECTION SWITCH  
 PART NO: M5-1616E  
 WEBSITE: www.ycelectron.com  
 REV: A UNIT: mm SCALE: / SHEET: A4